

3. Low Pressure Valve Plate Assembly - Model 2475

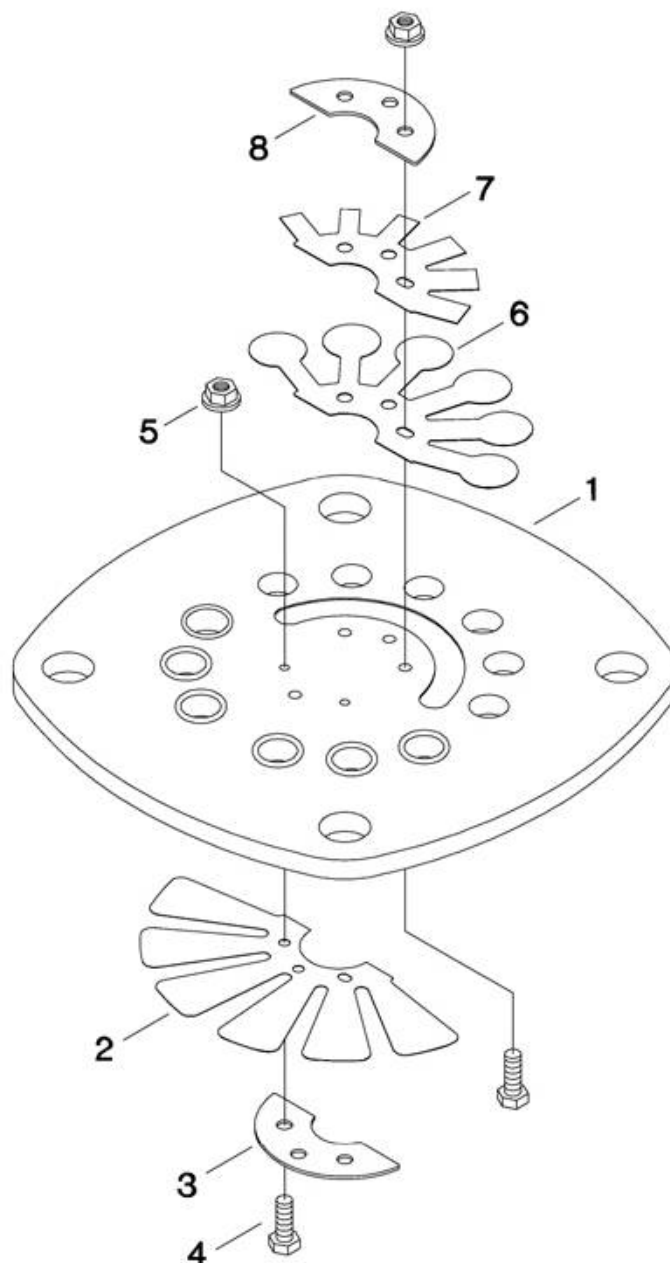

All manufacturer's names, numbers, photos, product description and/or part numbers are used for reference purposes only & it is not implied that any part listed is the product of these manufacturers. Since Approvement are made from time to time, the illustration and specifications are subject to change without notice.

3. Low Pressure Valve Plate Assembly - Model 2475

| REF. NO. | PART NO. | DESCRIPTION | QTY. | SPARES | | |
|----------|----------|----------------------------------|------|--------|---|---|
| | | | | 1 | 2 | 3 |
| REF. | 32248205 | ASSEMBLY, VALVE PLATE | 1 | | | |
| 3-1 | NSS | ● PLATE, VALVE - LOW PRESSURE | 1 | | 1 | 1 |
| 3-2 | 32248130 | ● VALVE, FINGER - INLET | 1 | 1 | 1 | 2 |
| 3-3 | 32248148 | ● RETAINER, FINGER VALVE - INLET | 1 | | | |
| 3-4 | 32247512 | ● SCREW, HEX HEAD - M4 X 12 | 6 | | | |
| 3-5 | 32248171 | ● NUT, HEX - M4 WITH LOCKWASHER | 6 | | | |
| 3-6 | 32248155 | ● VALVE, FINGER - DISCHARGE | 1 | 1 | 1 | 2 |
| 3-7 | 32294464 | ● VALVE, DAMPER - DISCHARGE | 1 | | | |
| 3-8 | 32248163 | ● VALVE, RETAINER - DISCHARGE | 1 | | | |

All manufacturer's names, numbers, photos, product description and/or part numbers are used for reference purposes only & it is not implied that any part listed is the product of these manufacturers. Since Approvement are made from time to time, the illustration and specifications are subject to change without notice.